

DPB14 – 14mm Fastflo™ in low-profile diffuser panels installed between battens

Supplied by Nu-Heat

14mm Fastflo™ tubing
Nu-Heat TriPanel –
25mm EHD polystyrene
Heat transfer plates

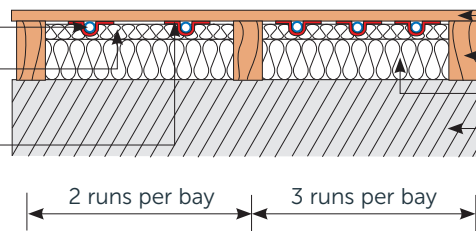

Supplied by others

Floor deck (see below)
Supporting battens fixed to sub-deck
Floor insulation
Floor structure (concrete or timber)

FLOOR HEATING TUBE

Nu-Heat's 14mm Fastflo™ tubing is extremely flexible which means that it can easily be installed around the numerous turns typical to any design. The use of multiple, shorter Fastflo™ coils within each temperature control zone means the tubing is installed at closer centres to ensure a more even heat distribution.

INSULATION

For concrete sub floors, or timber floors where insulation must sit above the deck, a minimum of 70mm 'celotex' or equivalent (or to building regulations Part L; whichever is greater) should be present below the diffuser panels.

FLOOR DECK

Laminate floors between 20 and 30mm thick may be laid on up to 3mm thick non-felt underlay directly onto the underfloor heating. Areas to be tiled can be covered by a plywood deck instead of chipboard. A quality two-part adhesive may then be used for fixing the tiles. For other areas 18 – 22mm chipboard deck may be used. The overall thickness of the deck should not exceed 30mm unless this has been agreed with a Nu-Heat Design Engineer.

FLOOR COVERINGS

Tiles, stone and thin laminates offer benefits such as improved response time and higher heat output. Carpets can be used but the Tog value when combined with performance underlay should be no greater than 2.5. If the system is powered by a heat pump greater restrictions apply. Natural timber with a low moisture content can be used, but care must be taken to properly acclimatise the wood by following manufacturers' instructions.

WARRANTIES/INSURANCE

Manufacturer's warranty: all UFH tube supplied by Nu-Heat is covered by a 50-year warranty, the first 10 years of which are insurance-backed.

Product liability: Nu-Heat maintains product liability insurance to £5 million.

Professional indemnity: As Nu-Heat's design service is integral to the operational effectiveness of the UFH system, the company holds professional indemnity insurance of £5 million to cover all aspects of our consultation and design services.

