

ALPB10 – 10mm Fastflo™ in pre-routed LoPro™10 panel in an acoustic floor with battens

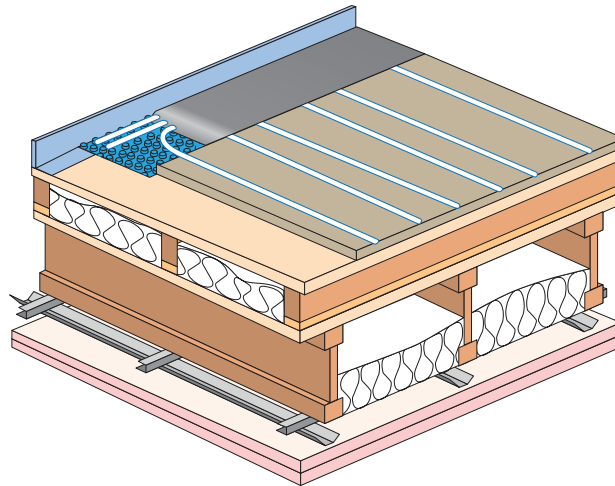

ALPB10

- Ideal for use in flats, apartments, renovation projects and commercial conversions
- Overall floor detail & mass is equivalent to the specification set out within E-FT-1/2/3 & E-FS-2
- Can assist in exceeding Part E requirements when correctly installed as part of an acoustic floor cassette
- Acoustic and thermal mass incorporated with the unique 15mm panel
- Enhanced thermal conductivity and 150mm pipe centres offer increased heat output and thermal spread across the floor finish
- Allows completion of primary acoustic detail prior to commencing installation of underfloor heating
- Quick and easy to install – a unique approach that separates trades and can reduce overall length of site programme
- Accredited test results and full design indemnity
- Ideal substrate for all floor finishes, including tile and stone
- Sustainable – LoPro™10 panel has up to 50% recycled content.

For site-specific K11 floor cassette detail please contact Nu-Heat.

TECHNICAL SPECIFICATION

ALPB10 acoustic data

Airborne	62dB R _w
Impact	50dB L _{n, w}

LoPro™10 panel

Weight	16.7kg/m ²
Density	1100kg/m ³ min.
Standards	Manufactured to BS EN 15283-2:2008
Material	Gypsum fibre board
Dimensions	1200 x 600 x 15mm
Area	0.72m ² per board
Routing	ø10mm @ 150mm centres

HEAT OUTPUT

(m² °K/W)

Water temp	R = 0.05 (tile)	R = 0.1 (timber)	R = 0.2 (carpet)
45 °C flow (40 ° average)	74 W/m ²	56 W/m ²	36 W/m ²
55 °C flow (50 ° average)	100 W/m ² *	75 W/m ² *	54 W/m ²

Nominal value; output values vary depending on specific floor finish.

*Limited by floor covering surface temperature limit.

www.nu-heat.co.uk/floorspecs

Acoustic performance data is taken from tests carried out at the Sound Research Laboratories, Sudbury, in accordance with the relevant BS EN ISO standards. Laboratory performances stated are specific to the above system only, inclusive of all elements shown and correct installation and should be used for guidance only.

The information contained in this publication is believed to be current and accurate as at the date of publication but no warranty, express or implied is given. Updates will not be issued automatically.

Supplied by Nu-Heat

15mm LoPro™10 panel
10mm Fastflo™ tubing

Castellated panel/
QuickSet self-levelling
compound/
Edge isolation strip
(not illustrated)

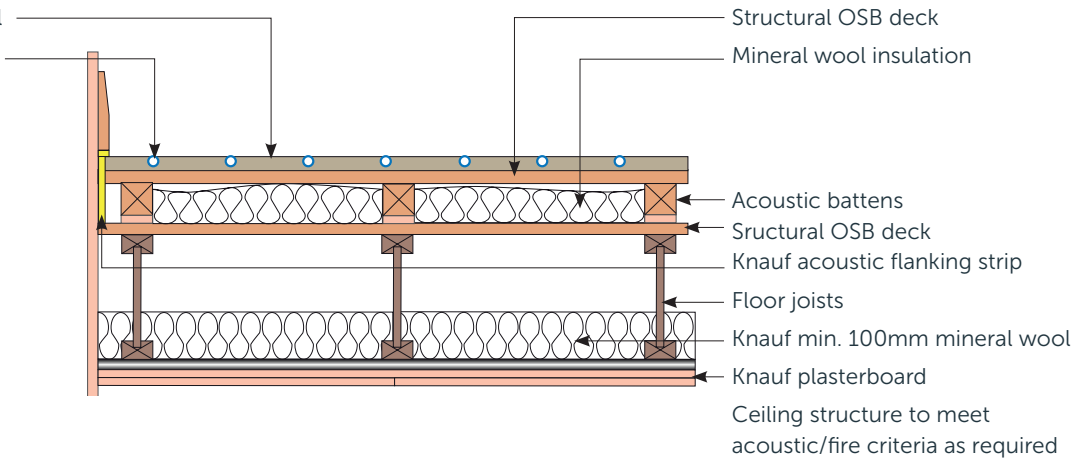
**DESCRIPTION**

LoPro™10 panel is a pre-routed 15mm gypsum panel that can be laid over new and existing floors. A castellated tray is fitted around the edge of the room to enable Fastflo™10 pipe to be conveniently fed into the panel and back to the manifold or zone distributor. The castellated tray is designed to guide the pipe through 180° bends and to enable multiple runs to be neatly and securely fixed.

FLOOR HEATING TUBE

Typically, a room or heating zone will use several coils of 10mm Fastflo™ pipe, each of shorter length than a single coil of larger diameter, providing a more even spread of warmth across the floor. Fastflo™'s flexibility also aids installation.

INSULATION

A minimum of 100mm of mineral wool insulation should be placed between the acoustic battens to reduce sound transmission. For floors over unheated areas, at least 150mm of mineral wool (or sufficient to meet building regulations Part L, whichever is greater) should be fitted between the joists.

UNDERFLOOR HEATING EFFICIENCY

Setting the room thermostat 1–2 °C lower achieves the same comfort levels as with an equivalent radiator system because the heat is mostly radiant, meaning air convection currents are minimised and heat loss by natural ventilation reduced. LoPro™10 is a perfect partner for modern gas, oil and LPG condensing boilers.

www.nu-heat.co.uk/floorspecs

FLOOR STRUCTURE

Individual LoPro™ panels are laid in brick-bond format. LoPro™10 can either be glued or screwed to the chipboard floor deck, depending on the nature of the final floor finish. A castellated tray is used to carry pipe to the manifolds. Once all floor heating pipe is installed the castellated tray is filled with the self-levelling compound supplied.

Virtually any covering can be applied over LoPro™10, but using less thermally resistive coverings ensures greater heat output and faster warm up times.

WARRANTIES/INSURANCE

Manufacturer's warranty: all UFH tube supplied by Nu-Heat is covered by a 50-year warranty, the first 10 years of which are insurance-backed.

Product liability: Nu-Heat maintains product liability insurance to £5 million.

Professional indemnity: As Nu-Heat's design service is integral to the operational effectiveness of the UFH system, the company holds professional indemnity insurance of £5 million to cover all aspects of our consultation and design services.

