

ASCE14 – 14mm Fastflo™ for acoustic sand & cement screed floors with edge insulation. Complies with Robust Detail E-FC-04; E-FC-6; E-FC-12; E-FC-13 or E-FC-14

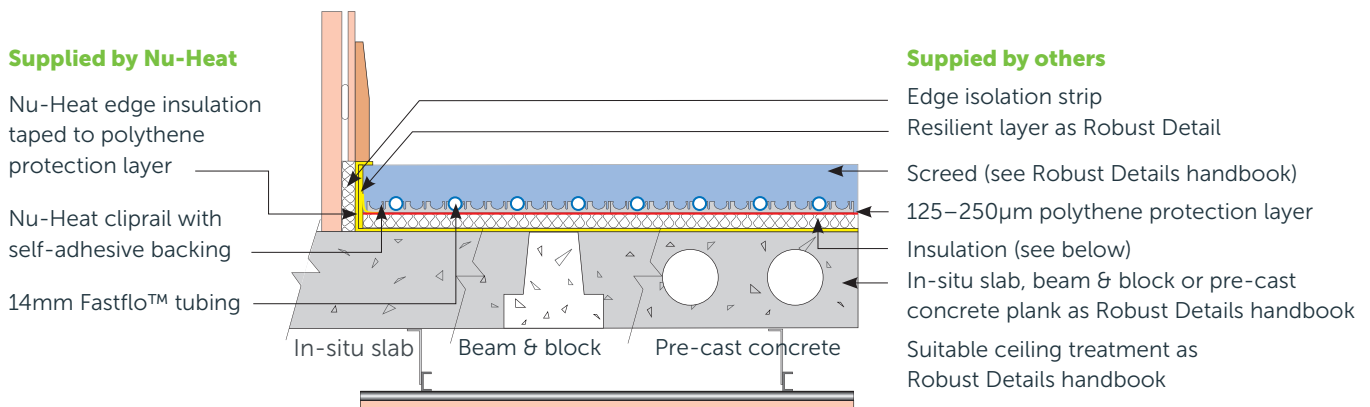

FLOOR HEATING TUBE

Nu-Heat's 14mm Fastflo™ tubing is extremely flexible which means that it can easily be installed around the numerous turns typical to any design. The use of multiple, shorter Fastflo™ coils within each temperature control zone means the tubing is installed at closer centres, suitable even for low temperature heat sources (e.g. heat pumps).

SCREED

Screed of 80kg/m² mass per unit area must be applied. Adding 1mm to the screed depth offsets the combined volume of pipe and cliprail. With sand and cement screeds the thickness should be a minimum of 65mm, with liquid screeds it should be at least 45mm. This depth should be measured at the centre of span of the pre-cast plank, hence the highest point of the floor.

INSULATION

Robust Details Ltd permit the use of underfloor heating systems that have a 'supporting layer/board' between the resilient layer and screed. Celotex (30mm minimum, 65mm maximum) type rigid board insulation (PIR/PUR) panel, should be positioned above the base resilient layer to provide an adequate level of thermal insulation which will expedite response times and enhance system control.

PIPE STAPLES

Pipe staples may be used and are supplied in a length that will not puncture the resilient layer.

EXPANSION JOINTS

Expansion joints must be incorporated in areas over 40m², or with length greater than 8m and across doorways and other changes of section. Where tube passes across expansion joints it must be covered with sleeving for at least 200mm either side.

RESILIENT LAYER

E-FC-4: IsoRubber by Thermal Economics.
 E-FC-6: Regupol E48 from CMS Acoustics.
 E-FC-12: IsoRubber Base HP3 by Thermal Economics.
 E-FC-13: IntaLay 65 by InstaCoustic Ltd.
 E-FC-14: IsoRubber by Thermal Economics.

EDGE ISOLATION STRIP

E-FC-4: IsoEdge flanking strip by Thermal Economics.
 E-FC-6: Resilient layer continues up wall.
 E-FC-12: IsoEdge flanking strip by Thermal Economics.
 E-FC-13: IntaLay 65 edge strip by InstaCoustic Ltd.
 E-FC-14: IsoEdge flanking strip by Thermal Economics.

USEFUL CONTACTS

Thermal Economics: Telephone: 01582 544255, Fax: 01582 429305, Web: www.thermal-economics.co.uk
CMS Acoustics: Telephone: 01925 577711, Fax: 01925 577733, Web: www.cmsacoustics.co.uk
Icopal-MONARFLOOR: Telephone: 01618 666540, Fax: 01618 666527, Web: www.icopal.co.uk
Instacoustics: Telephone: 01189 739560, Fax: 01189 739547, Web: www.instacoustics.uk

www.nu-heat.co.uk/floorspecs